



ROTATORI – ROTATORS

ROTATORI IDRAULICI – HYDRAULICS ROTATORS

VERSIONI AD ALBERO – SHAFT VERSION



MGR 15



MGR 35



MGR 50



MGR 55

| Modelli | Carico statico | Carico dinamico | Peso | Pressione | Rotazione | Coppia | Portata |
|---------------|--------------------|---------------------|---------------|--------------------|-----------------|---------------|-----------------|
| <i>Models</i> | <i>Static load</i> | <i>Dinamic load</i> | <i>Weight</i> | <i>W. pressure</i> | <i>Rotation</i> | <i>Torque</i> | <i>Oil flow</i> |
| | Kg | Kg | Kg | Bar | | Nm | l/min |
| MGR 12 | 1200 | 600 | 10 | 250 | 360° cont. | 500 | 10 |
| MGR 35 | 3500 | 1750 | 17 | 250 | 360° cont. | 900 | 20 |
| MGR 50 | 5000 | 2500 | 25 | 250 | 360° cont. | 1100 | 20 |
| MGR 55 | 5500 | 2700 | 28 | 250 | 360° cont. | 1300 | 20 |

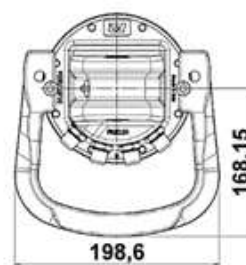
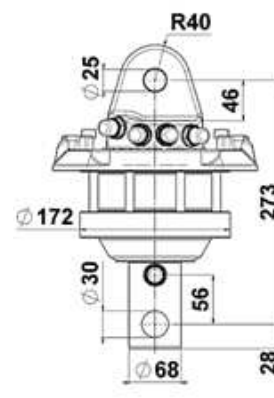
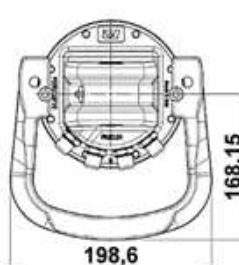
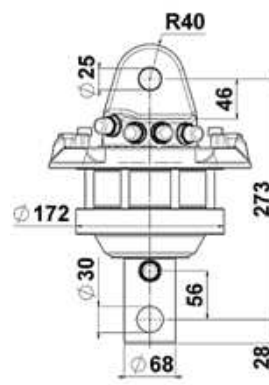
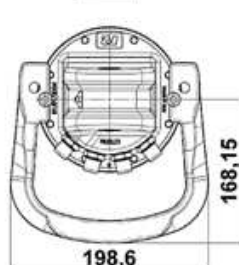
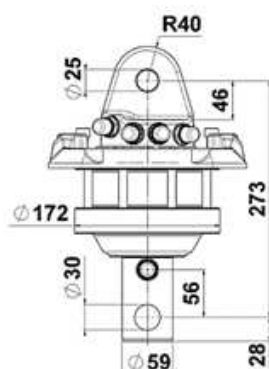
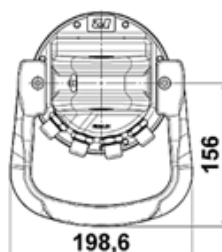
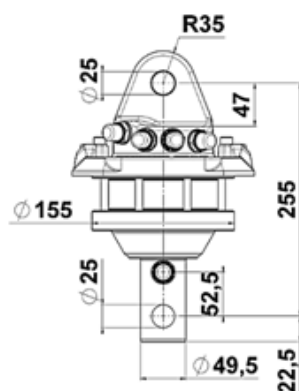

ROTATORI IDRAULICI – HYDRAULICS ROTATORS

VERSIONI AD ALBERO – SHAFT VERSION



MGH 70 DC

MGH 70 DC/2

MGH 120 DC

MGH 120 DC/2

| Modelli <i>Models</i> | Carico statico <i>Static load</i> | Carico dinamico <i>Dinamic load</i> | Peso <i>Weight</i> | Pressione <i>W. pressure</i> | Rotazione <i>Rotation</i> | Coppia <i>Torque</i> | Portata <i>Oil flow</i> |
|--------------------------|--------------------------------------|--|-----------------------|---------------------------------|------------------------------|-------------------------|----------------------------|
| | Kg | Kg | Kg | Bar | | Nm | l/min |
| MGR 70 DC*** | 7000 | 3500 | 36 | 250 | 360° cont. | 1900 | 25 |
| MGR 70 DC/2 | 7000 | 3550 | 38 | 250 | 360° cont. | 1900 | 25 |
| MGR 120 DC | 12000 | 6000 | 48 | 250 | 360° cont. | 2700 | 30 |
| M GR 120 DC/2 | 12000 | 6000 | 51 | 250 | 360° cont. | 2700 | 30 |

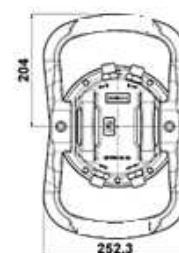
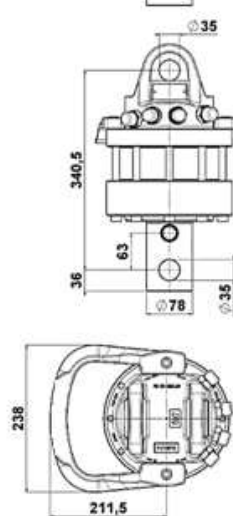
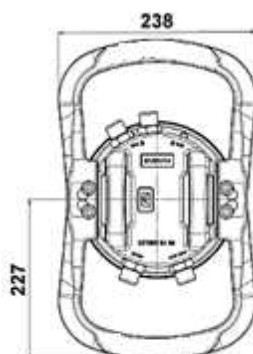
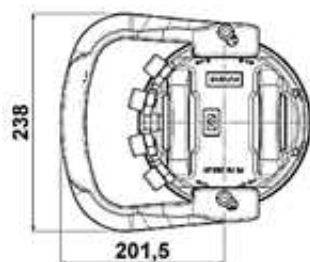
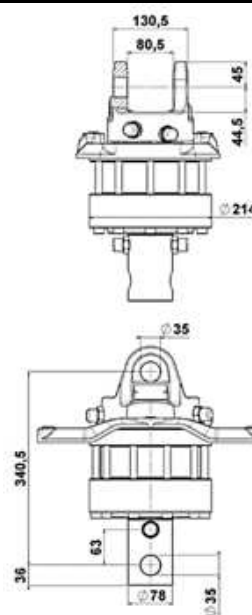
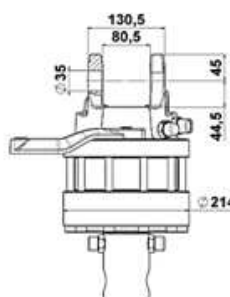
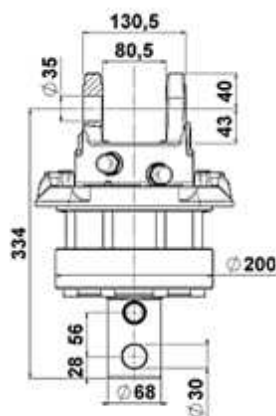
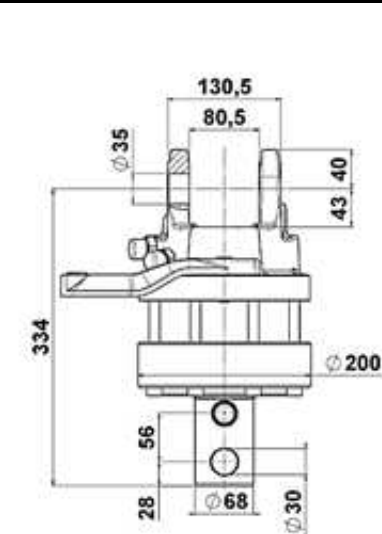

ROTATORI IDRAULICI – HYDRAULICS ROTATORS

VERSIONI FLANGIATE – FLANGED VERSION



MGR 35 F



MGR 50 F



MGR 55 R

| Modelli | Carico statico | Carico dinamico | Peso | Pressione | Rotazione | Coppia | Portata |
|-----------------|--------------------|---------------------|---------------|--------------------|-----------------|---------------|-----------------|
| <i>Models</i> | <i>Static load</i> | <i>Dinamic load</i> | <i>Weight</i> | <i>W. pressure</i> | <i>Rotation</i> | <i>Torque</i> | <i>Oil flow</i> |
| | Kg | Kg | Kg | Bar | | Nm | l/min |
| MGR 35 F | 3500 | 1750 | 22 | 250 | 360° cont. | 900 | 20 |
| MGR 50 F | 5000 | 2500 | 28 | 250 | 360° cont. | 1100 | 20 |
| MGR 55 F | 5500 | 2700 | 33 | 250 | 360° cont. | 1300 | 20 |

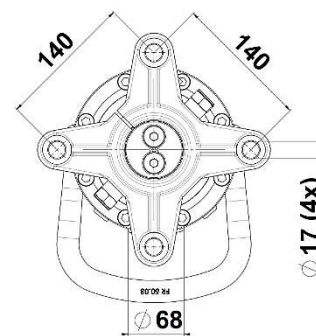
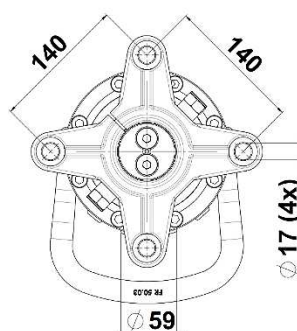
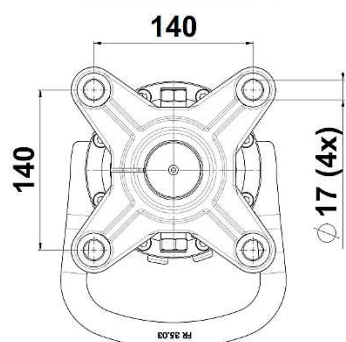
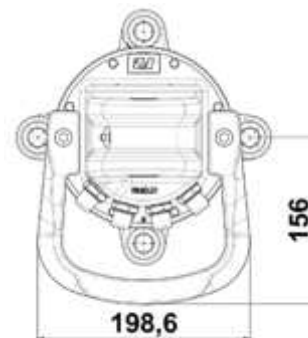
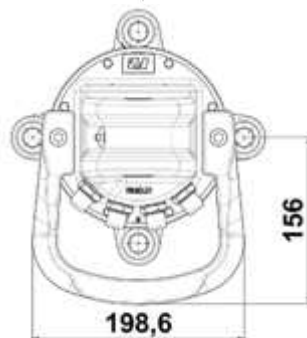
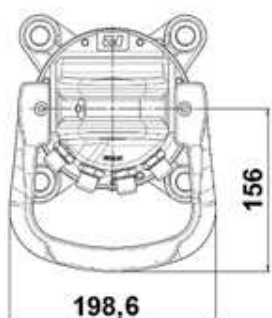
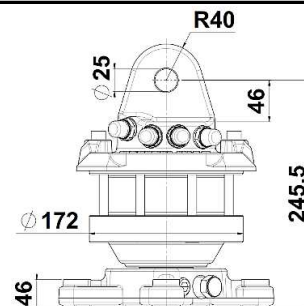
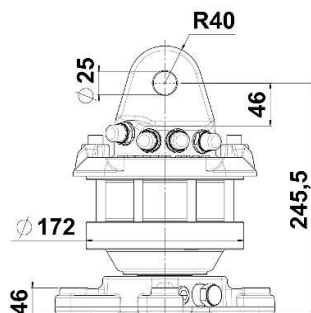
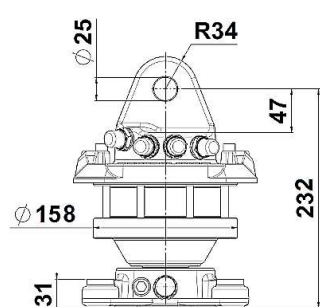

I dati possono essere variati senza preavviso – Technical data can be revised without prior notice

ROTATORI IDRAULICI – HYDRAULICS ROTATORS

VERSIONI FLANGIATE – FLANGED VERSION



MGR 70 DC-F

MGR 70 DC/2-F

MGR 120 DC-F

MGR 120 DC/2-F

| Modelli | Carico statico | Carico dinamico | Peso | Pressione | Rotazione | Coppia | Portata |
|-----------------|--------------------|---------------------|---------------|--------------------|-----------------|---------------|-----------------|
| <i>Models</i> | <i>Static load</i> | <i>Dinamic load</i> | <i>Weight</i> | <i>W. pressure</i> | <i>Rotation</i> | <i>Torque</i> | <i>Oil flow</i> |
| | Kg | Kg | Kg | Bar | | Nm | l/min |
| MGR 70 DC-F | 7000 | 3500 | 36 | 250 | 360° cont. | 1900 | 25 |
| MGR 70 DC/2-F | 7000 | 3550 | 38 | 250 | 360° cont. | 1900 | 25 |
| MGR 120 DC-F | 12000 | 6000 | 48 | 250 | 360° cont. | 2700 | 30 |
| M GR 120 DC/2-F | 12000 | 6000 | 51 | 250 | 360° cont. | 2700 | 30 |

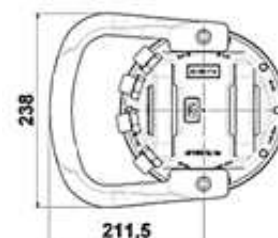
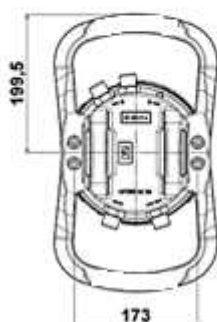
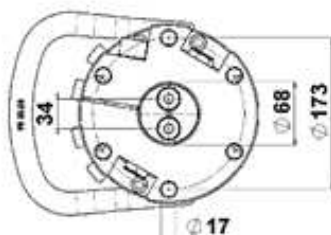
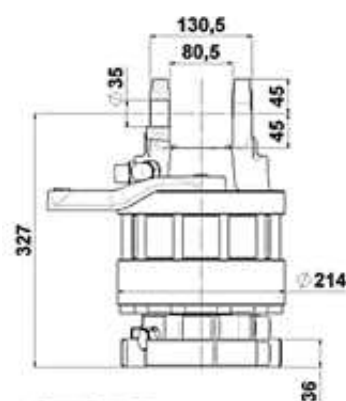
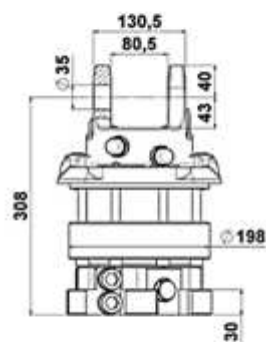
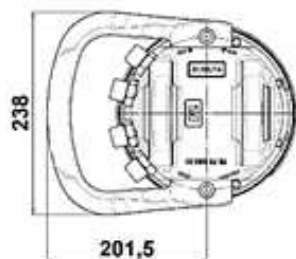
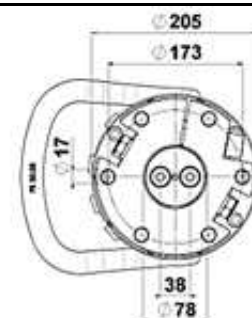
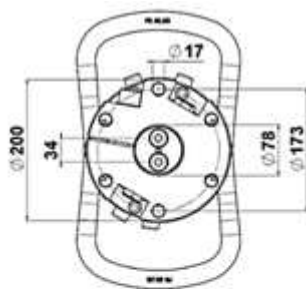
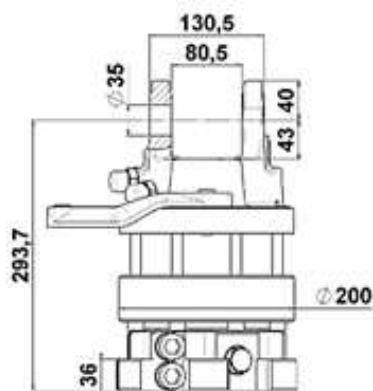

ROTATORI IDRAULICI – HYDRAULICS ROTATORS

VERSIONI FLANGIATE – FLANGED VERSION



MGR 170 DBX-F



MGR 120 F S6

| Modelli | Carico statico | Carico dinamico | Peso | Pressione | Rotazione | Coppia | Portata |
|--------------------|--------------------|---------------------|---------------|--------------------|-----------------|---------------|-----------------|
| <i>Models</i> | <i>Static load</i> | <i>Dinamic load</i> | <i>Weight</i> | <i>W. pressure</i> | <i>Rotation</i> | <i>Torque</i> | <i>Oil flow</i> |
| | Kg | Kg | Kg | Bar | | Nm | l/min |
| MGR170 DBXF | 17000 | 8500 | 70 | 250 | 360° cont. | 3400 | 40 |
| MGR120 FS6 | 12000 | 6000 | 77 | 250 | 360° cont. | 2900 | 35 |

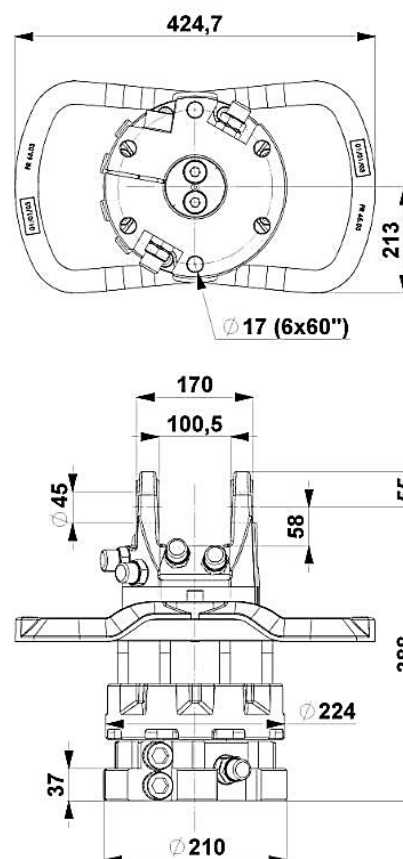
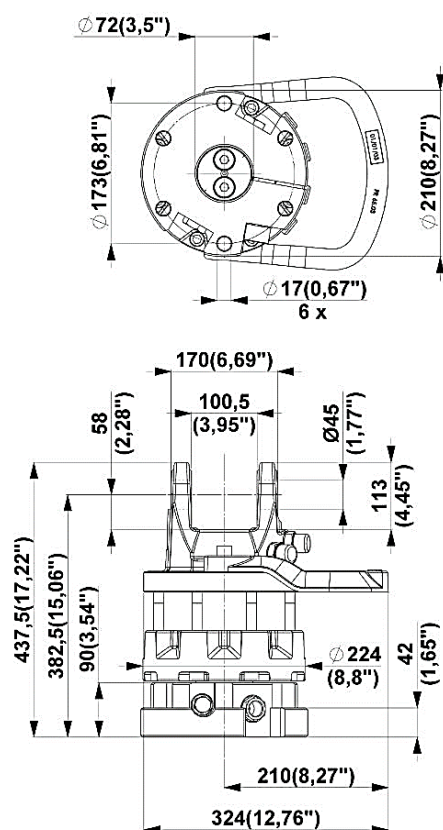

ROTATORI MECCANICI – MECHANICAL ROTATORS

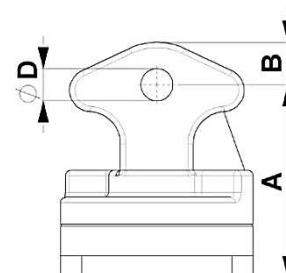
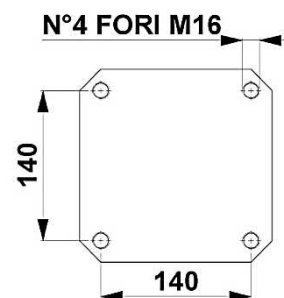
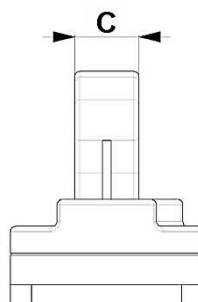
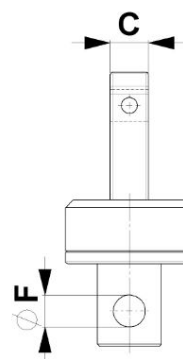
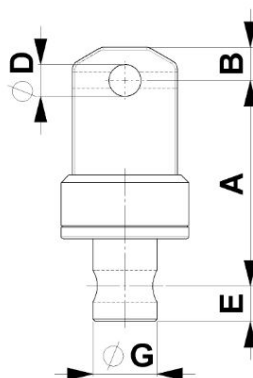

| Modelli | Carico statico | Peso | Rotazione | A | B | C | D | E | F | G |
|--------------------|--------------------|---------------|-----------------|-----------|-----------|-----------|-----------|-----------|-----------|-----------|
| <i>Models</i> | <i>Static load</i> | <i>Weight</i> | <i>Rotation</i> | <i>mm</i> | <i>mm</i> | <i>mm</i> | <i>mm</i> | <i>mm</i> | <i>mm</i> | <i>mm</i> |
| | Kg | Kg | | | | | | | | |
| MGR 10 M | 1000 | 7 | 250° | 166 | 38 | 30 | 25 | 28 | 25 | 49,5 |
| MGR 20 M | 2000 | 17 | 250° | 210 | 50 | 60 | 30 | 28 | 30 | 59 |
| MGR 20/40 M | 2000 | 19 | 250° | 175 | 50 | 60 | 30 | | | |

ATTACCHI A SOSPENSIONE – LINKS

**Universale - Universal**

| Universale <i>Universal</i> | | |
|--|-----------|------|
| Ø perno - pivot | mm | 25 |
| Ø boccola - bushing | mm | 45 |
| Portata massima <i>Maximum capacity</i> | kg | 5000 |
| Attacco a sospensione per FR 35/50 <i>Link for FR 35/50</i> | | |

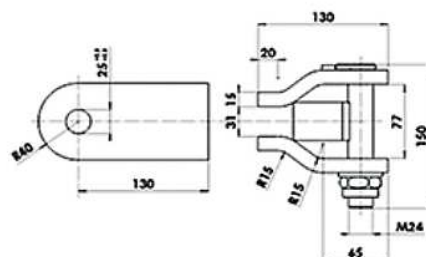

H1

| H1 | | |
|---|-----------|------|
| Ø perno - pivot | mm | 25 |
| Ø boccola - bushing | mm | 45 |
| Portata massima <i>Maximum capacity</i> | kg | 5000 |
| Attacco a sospensione per FR 35/50 <i>Link for FR 35/50</i> | | |

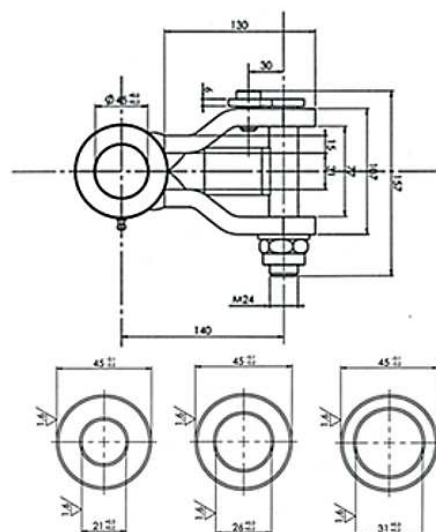

| Boccole adattatrici Adapting bushings | | |
|--|-----------|-----------|
| Ø interno <i>Ø internal</i> | mm | 21 |
| Ø interno <i>Ø internal</i> | mm | 26 |
| Ø interno <i>Ø internal</i> | kg | 31 |

Per le diverse estremità del lato gru
For the different crane side extremities



FL 65-110/150



FL 65-110/240

| FL 65-110/150 - FL 65-110/240 | | |
|---|----|-------|
| Ø perno lato rotatore Ø pivot rotator side | mm | 35 |
| Ø boccola lato gru Ø bushing crane side | mm | 30 |
| Ø boccola lato gru Ø bushing crane side | mm | 35 |
| Ø boccola lato gru Ø bushing crane side | mm | 40 |
| Ø boccola lato gru Ø bushing crane side | mm | 45 |
| Portata massima Maximum capacity | kg | 11000 |
| Attacco a sospensione per FR 65-110 Link for FR 65-110 | | |

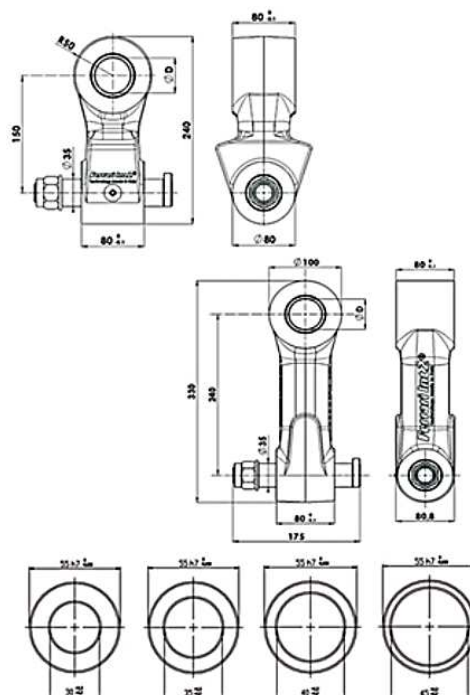

ATTENZIONE! KIT PERNO NON INCLUSO
ATTENTION! PIN AND NUT NOT INCLUDED

I dati possono essere variati senza preavviso – Technical data can be revised without prior notice

IDENTIFICAZIONE ATTACCO A SOSPENSIONE – LINK IDENTIFICATION



TIPO “ F ”

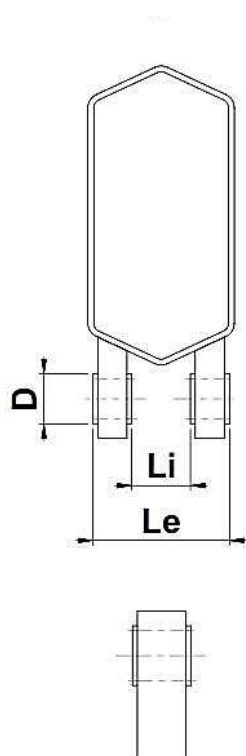

TIPO “ M ”

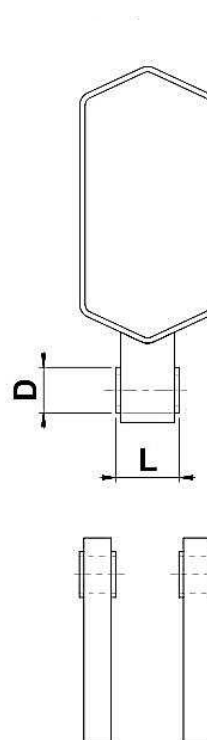

Schema identificazione tipologia di attacco gru

Identification crane attachment type

| Tipo | D | Li | Le | L |
|------|----|----|----|----|
| | mm | mm | mm | mm |
| F | | | | |
| M | | | | |

GANCI ROTANTI FRG – FRG ROTATING HOOKS



FRG
GANCIO ROTANTE
ROTATING HOOK

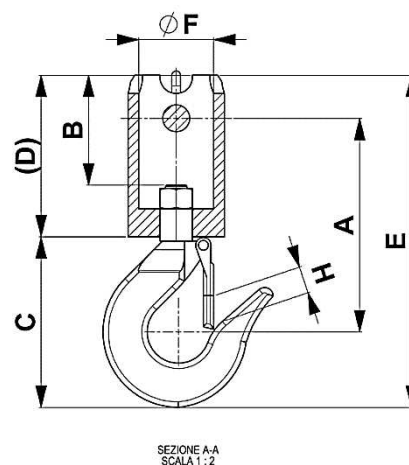
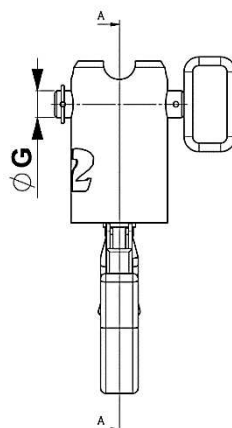

| Modelli Models | A | B | C | D | E | F | G | H | Portata Lifting capacity |
|--------------------------|-----|----|-----|-----|-----|------|----|----|-----------------------------|
| | mm | mm | mm | mm | mm | mm | mm | mm | mm |
| FRG 35/50 - 5 T D25/41 | 222 | 85 | 168 | 150 | 318 | 50 | 25 | 41 | 3500 |
| FRG 50/59 - 5 T D26/41 | 222 | 85 | 168 | 150 | 318 | 59,5 | 26 | 41 | 3500 |
| FRG 50/59 - 5 T D30/41 | 222 | 85 | 168 | 150 | 318 | 59,5 | 30 | 41 | 3500 |
| FRG 50/59 - 7,5 T D26/57 | 254 | 85 | 210 | 150 | 360 | 59,5 | 26 | 57 | 3500 |
| FRG 50/59 - 7,5 T D30/57 | 254 | 85 | 210 | 150 | 360 | 59,5 | 30 | 57 | 3500 |
| FRG 50/68 - 5 T D30/41 | 222 | 85 | 168 | 150 | 360 | 68,5 | 30 | 57 | 3500 |
| FRG 50/69 - 5 T D30/41 | 222 | 85 | 168 | 150 | 318 | 69,5 | 30 | 41 | 3500 |
| FRG 50/69 - 7,5 T D30/41 | 254 | 85 | 210 | 150 | 360 | 69,5 | 30 | 57 | 3500 |
| FRG 75/68 - 7,5 T D30/57 | 254 | 85 | 210 | 150 | 360 | 68,5 | 30 | 57 | 3500 |

Adatto per tutti i tipi di rotatori - Suitable for all hydraulic rotators

GANCI ROTANTI FRG – FRG ROTATING HOOKS



FRG S

GANCIO ROTANTE E BASCULANTE
ROTATING AND TILTING HOOK

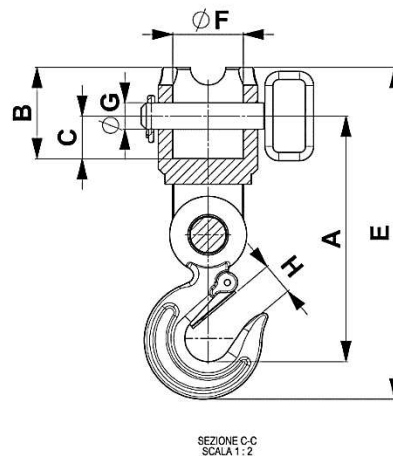
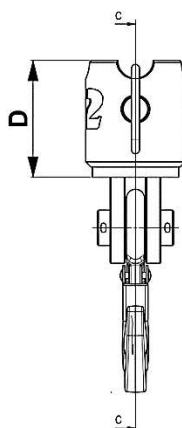

| Modelli Models | A | B | C | D | E | F | G | H | Portata Lifting capacity |
|-------------------------|-----|----|----|-----|-----|------|----|----|-----------------------------|
| | mm | mm | mm | mm | mm | mm | mm | mm | mm |
| FRG 50/59 S - 5 T D26 | 242 | 90 | 42 | 115 | 327 | 59,5 | 26 | 30 | 5000 |
| FRG 50/59 S - 5 T D30 | 242 | 90 | 42 | 115 | 327 | 59,5 | 30 | 30 | 5000 |
| FRG 50/69 S - 5 T D30 | 242 | 90 | 42 | 115 | 327 | 69,5 | 30 | 30 | 5000 |
| FRG 55/68 S - 5 T D30 | 242 | 90 | 42 | 115 | 327 | 68,5 | 30 | 30 | 5000 |
| FRG 55/69 S - 5 T D30 | 242 | 90 | 42 | 115 | 327 | 69,5 | 30 | 30 | 5000 |
| FRG 55/68 S - 7,5 T D30 | 288 | 90 | 42 | 115 | 383 | 68,5 | 30 | 38 | 7500 |
| FRG 55/69 S - 7,5 T D30 | 288 | 90 | 42 | 115 | 383 | 69,5 | 30 | 38 | 7500 |
| FRG 75/68 S - 7,5 T D30 | 288 | 90 | 42 | 115 | 383 | 68,5 | 30 | 38 | 7500 |
| FRG 75/69 S - 7,5 T D30 | 288 | 90 | 42 | 115 | 383 | 69,5 | 30 | 38 | 7500 |
| FRG 125/78 S - 10 T D35 | 336 | 90 | 42 | 115 | 441 | 78,5 | 35 | 50 | 10000 |

Adatto per tutti i tipi di rotatori - Suitable for all hydraulic rotators



M.G.H. SRL

VIA G.BOVINI, 43/8

48123 RAVENNA – ITALY

Tel. +39/(0)544-502432 – Fax. +39/(0)544-460754

Mail: info@mghsrl.eu

commerciale@mghsrl.eu



Terra Cielo Mare

